

# Courtyard Plaza

SEC of I-35 and FM 725  
New Braunfels, TX 78130  
[www.cbre.com/southcentralretail](http://www.cbre.com/southcentralretail)

Up to 40,000 SF of Box Space Available



# Property Overview

## Shopping Center Details

- + Available
  - Suite 151 2,574 SF
  - Suite 159 20,000 SF
  - Suite 161 23,280 SF
- + Rate
  - Please contact broker.
- + NNN Charges
  - CAM \$1.70 PSF
  - Ins. \$0.78 PSF
  - Tax \$3.81 PSF
  - Total \$6.29 PSF**

## Property Highlights

- + Located in New Braunfels, Texas, in the heart of the Austin to San Antonio corridor on I-35
- + Excellent access and visibility to I-35 with over 126,000 vpd
- + Pylon signage available on property

## Key Tenants

- + Big Lots
- + Dollar Tree
- + Harbor Freight Tools
- + dd's Discount
- + Cici's Pizza



## Contact Us

**Price Onken**  
First Vice President  
+1 210 841 3243  
price.onken@cbre.com

**Joe Cukjati**  
Senior Associate  
+1 210 841 3227  
joe.cukjati@cbre.com



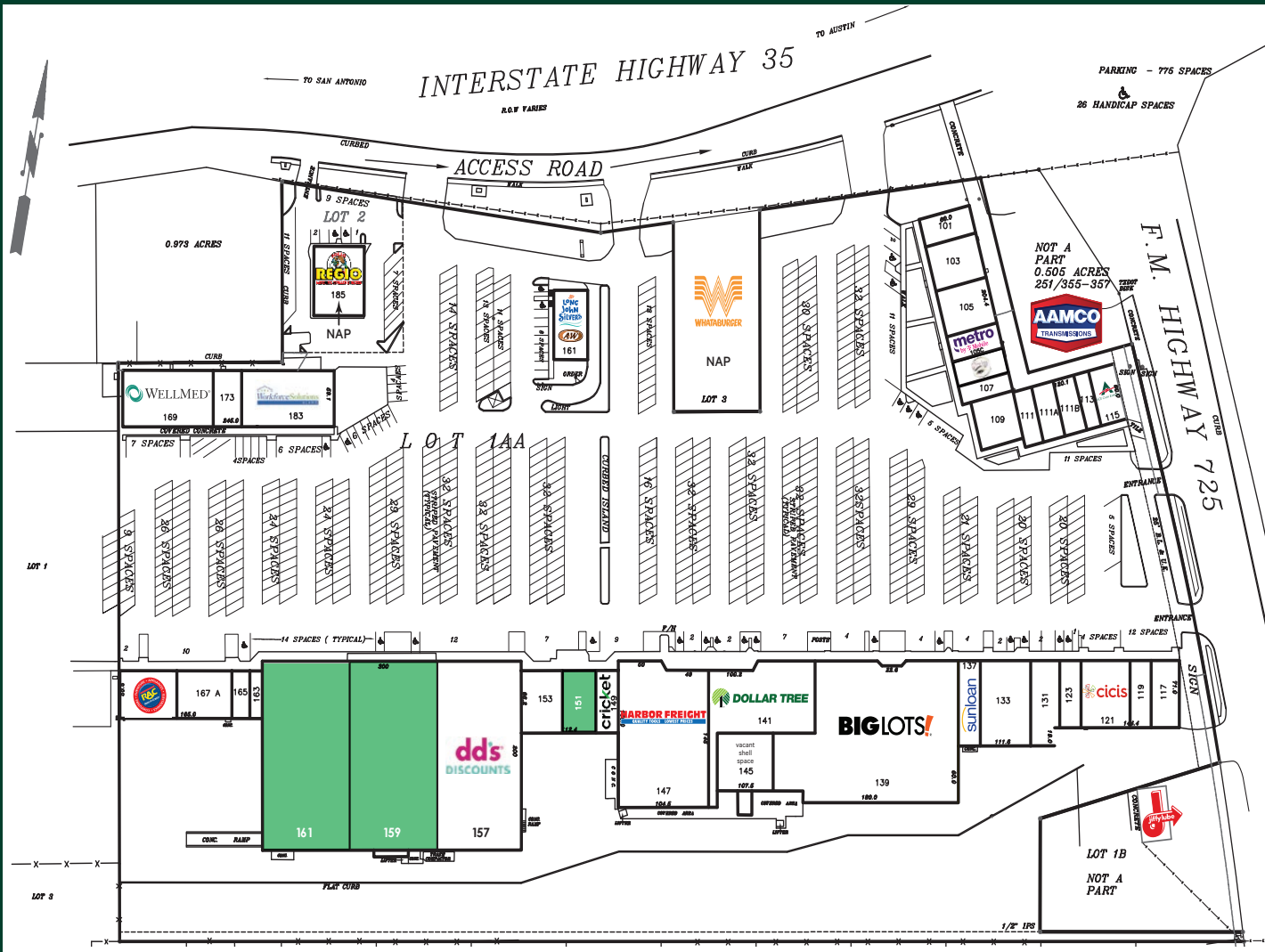

Suite	Tenant	Size
101	Texas State Optical	1,800 SF
103	China Kitchen	2,900 SF
105	Taqueria Guadalajara	3,000 SF
105C	Metro PCS	1,080 SF
106A	Fairy Lash	2,160 SF
107	Beauty Plex	1,200 SF
109	Clinica Familiar	2,500 SF
111	Los Cristales	1,315 SF
111A	Paeteria La Reina	1,225 SF
111B	Dental Plus Clinic	1,875 SF
113	Donut Palace	1,020 SF
115	Ace Cash Express	1,800 SF
117	K&B Liquors	2,272 SF
119	LA Insurance	1,731 SF
121	Cici's Pizza	4,032 SF
123	San Anthony Jewelry	1,756 SF
131	Footy Rooty	2,565 SF
133	Guadalajara Meat Market	5,247 SF
137	Sun Loan	2,291 SF
139	Big Lots	30,000 SF
141	Dollar Tree	8,690 SF
145	Vacant Shell Space	3,940 SF
147	Harbor Freight Tools	15,260 SF
149	Cricket Wireless	1,716 SF
151	Available	2,574 SF
153	Kuhl River Day Spa	3,160 SF
157	dd's Discounts	20,000 SF
159	Available	20,000 SF
161	Available	23,280 SF
163	DP Nails	757 SF
165	TMD Staffing	1,010 SF
167A	SBG Texas	3,500 SF
167B	Rent-A-Center	3,056 SF
169	WellMed	6,300 SF
173	Lone Star Spine & Rehab	1,700 SF
183	Alamo Workforce Solutions	5,640 SF
185	Pollo Regio	4,002 SF
161	Long John Silver's/A&W	2,607 SF





# Courtyard Plaza

SEC of I-35 and FM 725 | New Braunfels, TX 78130

# For Lease









# Courtyard Plaza

SEC of I-35 and FM 725 | New Braunfels, TX 78130

For Lease

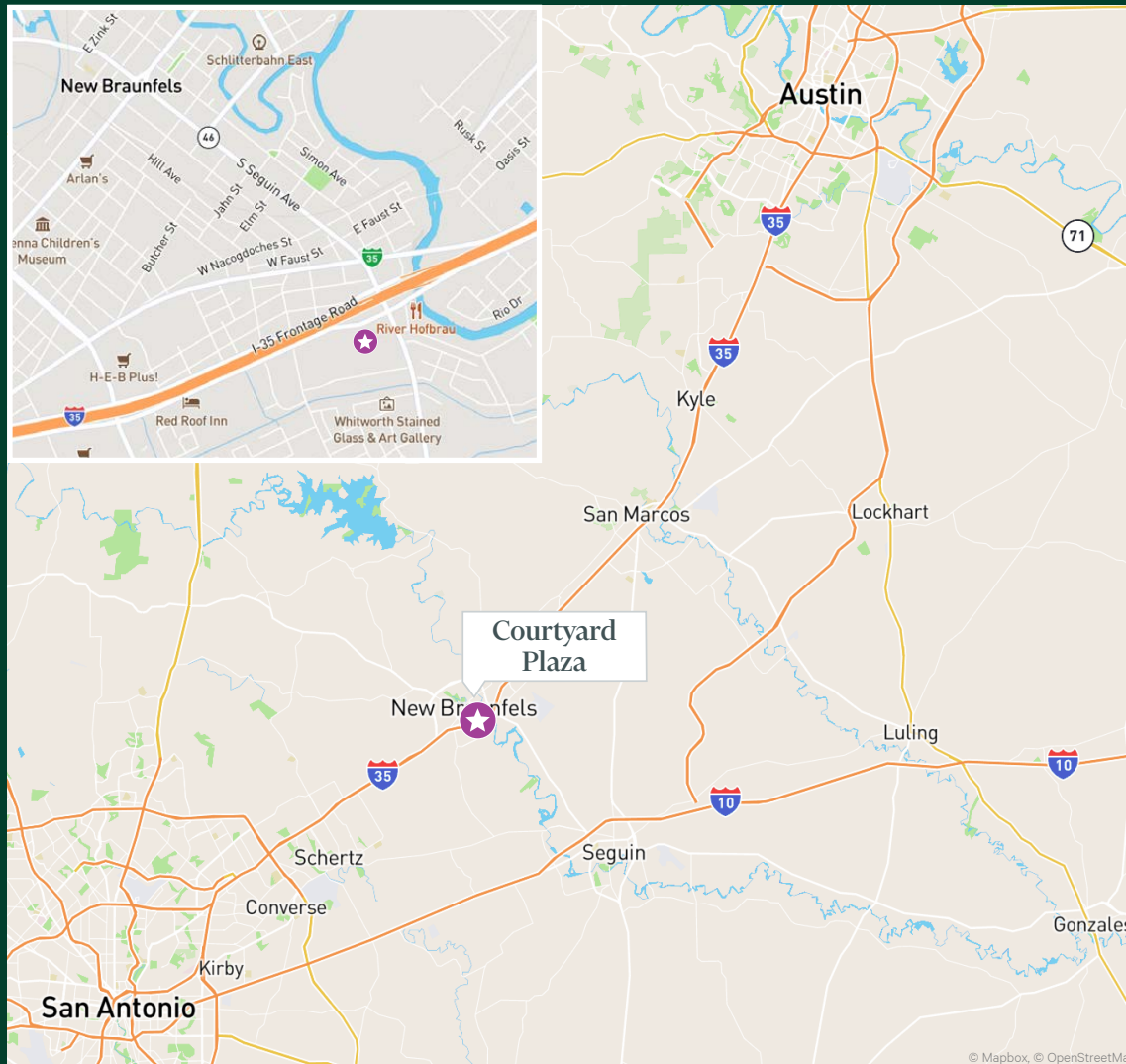

## Trade Area Information

Demographic Summary	1 Mile	3 Miles	5 Miles
2022 Population	7,057	67,190	104,219
2022 Daytime Population	10,411	67,670	103,064
2027 Population-5Yr Projection	7,285	71,604	117,465
2022 Households	2,740	25,564	39,439
2022 Avg. HH Income	\$84,400	\$100,0617	\$105,785
2022 Median Age	37.3	36.8	37.5

### Traffic Counts

I-35	126,365 vpd
FM 725	25,431 vpd

Source: TxDot, 2021

© 2023 CBRE, Inc. All rights reserved. This information has been obtained from sources believed reliable, but has not been verified for accuracy or completeness. You should conduct a careful, independent investigation of the property and verify all information. Any reliance on this information is solely at your own risk. CBRE and the CBRE logo are service marks of CBRE, Inc. All other marks displayed on this document are the property of their respective owners, and the use of such logos does not imply any affiliation with or endorsement of CBRE. Photos herein are the property of their respective owners. Use of these images without the express written consent of the owner is prohibited.

# Information About Brokerage Services

Texas law requires all real estate license holders to give the following information about brokerage services to prospective buyers, tenants, sellers and landlords.



## TYPES OF REAL ESTATE LICENSE HOLDERS:

- A **BROKER** is responsible for all brokerage activities, including acts performed by sales agents sponsored by the broker.
- A **SALES AGENT** must be sponsored by a broker and works with clients on behalf of the broker.

## A BROKER'S MINIMUM DUTIES REQUIRED BY LAW (A client is the person or party that the broker represents):

- Put the interests of the client above all others, including the broker's own interests;
- Inform the client of any material information about the property or transaction received by the broker;
- Answer the client's questions and present any offer to or counter-offer from the client; and
- Treat all parties to a real estate transaction honestly and fairly

## A LICENSE HOLDER CAN REPRESENT A PARTY IN A REAL ESTATE TRANSACTION:

**AS AGENT FOR OWNER (SELLER/LANDLORD):** The broker becomes the property owner's agent through an agreement with the owner, usually in a written listing to sell or property management agreement. An owner's agent must perform the broker's minimum duties above and must inform the owner of any material information about the property or transaction known by the agent, including information disclosed to the agent or subagent by the buyer or buyer's agent.

**AS AGENT FOR BUYER/TENANT:** The broker becomes the buyer/tenant's agent by agreeing to represent the buyer, usually through a written representation agreement. A buyer's agent must perform the broker's minimum duties above and must inform the buyer of any material information about the property or transaction known by the agent, including information disclosed to the agent by the seller or seller's agent.

**AS AGENT FOR BOTH - INTERMEDIARY:** To act as an intermediary between the parties the broker must first obtain the written

agreement of each party to the transaction. The written agreement must state who will pay the broker and, in conspicuous bold or underlined print, set forth the broker's obligations as an intermediary. A broker who acts as an intermediary:

- Must treat all parties to the transaction impartially and fairly;
- May, with the parties' written consent, appoint a different license holder associated with the broker to each party (owner and buyer) to communicate with, provide opinions and advice to, and carry out the instructions of each party to the transaction.
- Must not, unless specifically authorized in writing to do so by the party, disclose:
  - that the owner will accept a price less than the written asking price;
  - that the buyer/tenant will pay a price greater than the price submitted in a written offer; and
  - any confidential information or any other information that a party specifically instructs the broker in writing not to disclose, unless required to do so by law.

**AS SUBAGENT:** A license holder acts as a subagent when aiding a buyer in a transaction without an agreement to represent the buyer. A subagent can assist the buyer but does not represent the buyer and must place the interests of the owner first.

## TO AVOID DISPUTES, ALL AGREEMENTS BETWEEN YOU AND A BROKER SHOULD BE IN WRITING AND CLEARLY ESTABLISH:

- The broker's duties and responsibilities to you, and your obligations under the representation agreement.
- Who will pay the broker for services provided to you, when payment will be made and how the payment will be calculated.

**LICENSE HOLDER CONTACT INFORMATION:** This notice is being provided for information purposes. It does not create an obligation for you to use the broker's services. Please acknowledge receipt of this notice below and retain a copy for your records.

**CBRE, Inc.**

Licensed Broker/Broker Firm Name or Primary Assumed Business Name

**299995**

License No.

**texaslicensing@cbre.com**

Email

**+1 210 225 1000**

Phone

**Christopher Hipps**

Designated Broker of Firm

**326345**

License No.

**chris.hipps@cbre.com**

Email

**+1 214 979 6199**

Phone

**Gardner Peavy**

Licensed Supervisor of Sales Agent/Associate

**473833**

License No.

**gardner.peavy@cbre.com**

Email

**+1 210 253 6031**

Phone

**Price Onken**

Sales Agent/Associate's Name

**570479**

License No.

**price.onken@cbre.com**

Email

**+1 210 841 3243**

Phone

Buyer/Tenant/Seller/Landlord Initials

Date

